

REVISIONS		
DATE	NAME	NUMBER
4/1/97	CHARLES J. RIEBEL JR.	29286
1/18/99	CHARLES J. RIEBEL JR.	29286
1/7/00	CHARLES J. RIEBEL JR.	29286
12/2000	CHARLES J. RIEBEL JR.	29286
7/11/01	CHARLES J. RIEBEL JR.	29286
3/24/05	CHARLES J. RIEBEL JR.	29286
8/11/05	CHARLES J. RIEBEL JR.	29286

I HEREBY CERTIFY THAT THIS MAP HAS BEEN REVISED UNDER MY IMMEDIATE SUPERVISION, AND COMPLIES WITH THE LAWS OF THE STATE OF NEW JERSEY.

*Charles J. Riebel Jr.*  
 CHARLES J. RIEBEL JR. No. 29286

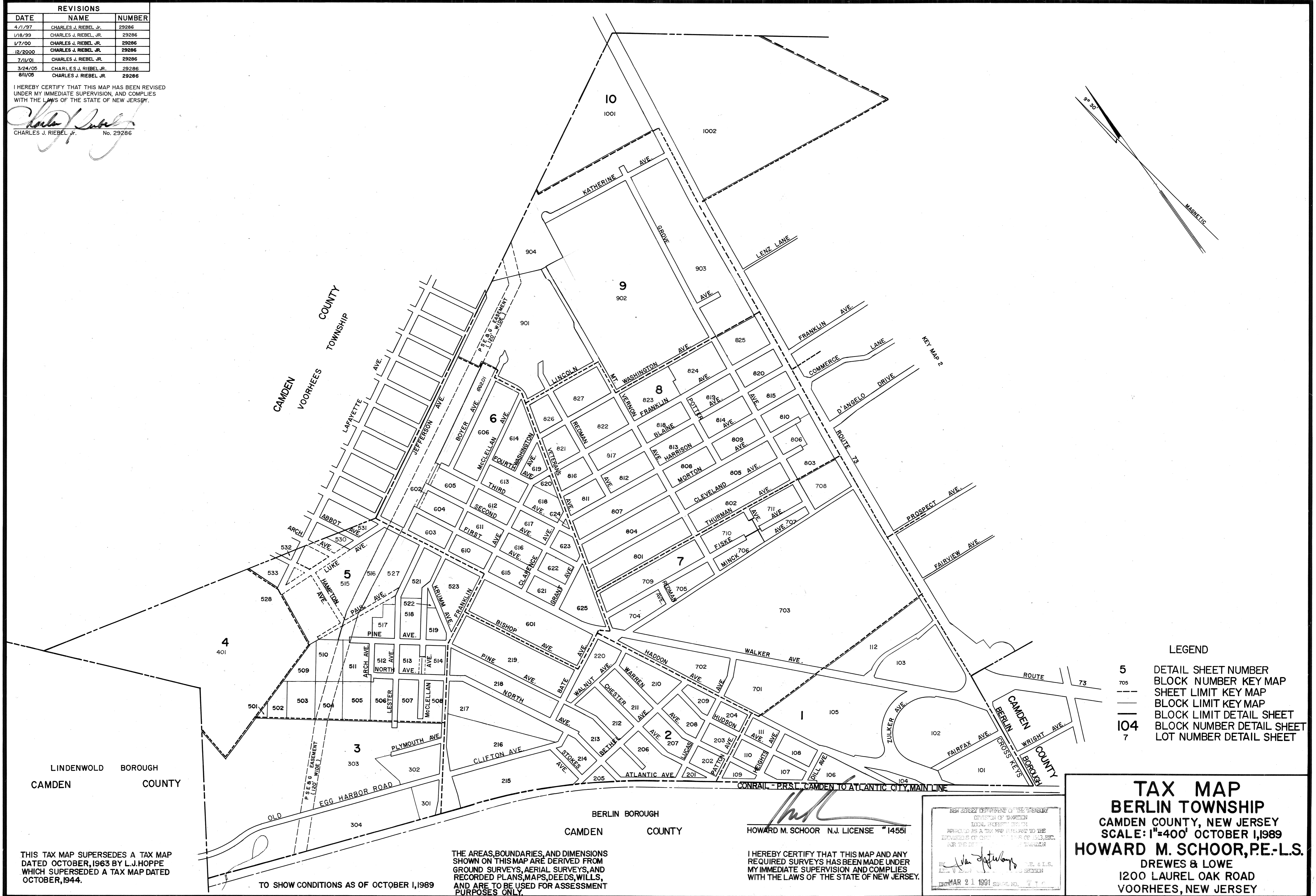
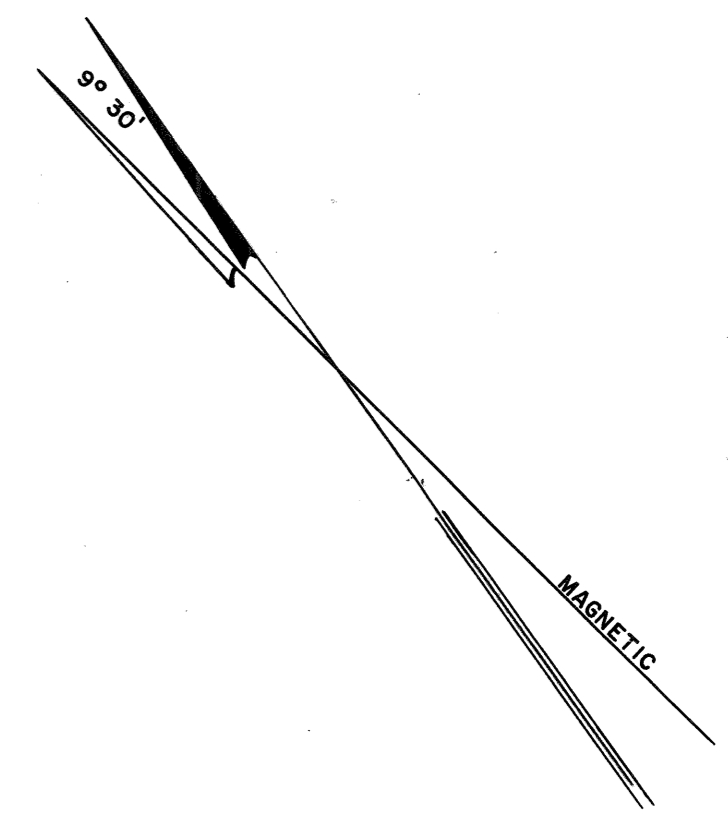

LEGEND

5	DETAIL SHEET NUMBER
705	BLOCK NUMBER KEY MAP
---	SHEET LIMIT KEY MAP
---	BLOCK LIMIT KEY MAP
---	BLOCK LIMIT DETAIL SHEET
104	BLOCK NUMBER DETAIL SHEET
7	LOT NUMBER DETAIL SHEET

**TAX MAP**  
**BERLIN TOWNSHIP**  
 CAMDEN COUNTY, NEW JERSEY  
 SCALE: 1"=400' OCTOBER 1, 1989  
**HOWARD M. SCHOOR, P.E.-L.S.**  
 DREWES & LOWE  
 1200 LAUREL OAK ROAD  
 VOORHEES, NEW JERSEY

THIS TAX MAP SUPERSEDES A TAX MAP DATED OCTOBER, 1963 BY L.J.HOPPE WHICH SUPERSEDED A TAX MAP DATED OCTOBER, 1944.

THE AREAS, BOUNDARIES, AND DIMENSIONS SHOWN ON THIS MAP ARE DERIVED FROM GROUND SURVEYS, AERIAL SURVEYS, AND RECORDED PLANS, MAPS, DEEDS, WILLS, AND ARE TO BE USED FOR ASSESSMENT PURPOSES ONLY.

HOWARD M. SCHOOR N.J. LICENSE #14551

I HEREBY CERTIFY THAT THIS MAP AND ANY REQUIRED SURVEYS HAS BEEN MADE UNDER MY IMMEDIATE SUPERVISION AND COMPLIES WITH THE LAWS OF THE STATE OF NEW JERSEY.

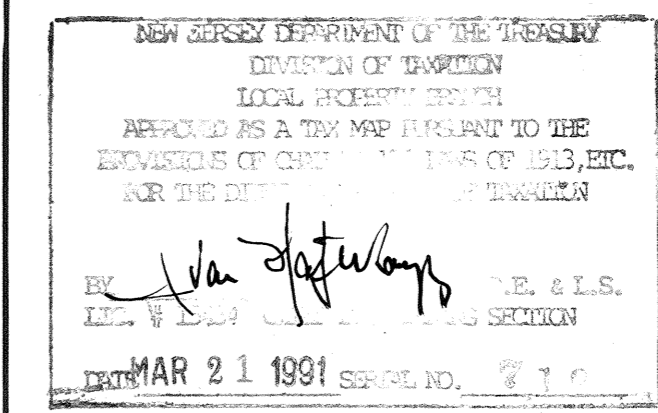

TO SHOW CONDITIONS AS OF OCTOBER 1, 1989